



**Specification**

**DESIGN**

One-piece valve body, robust and resistant to deformation, avoiding possible leaks of the half-body type;  
 Prefabricated support plate, robust, lightweight, epoxy painted; Protective steel or stainless steel with mounting holes for mounting equipment; limit switches, solenoid valves, protective covers (CE); Knife gates finished and polished; Position indicators to indicate the position of the valve plate; No damage to the valve seat

**OPERATION**

Manual, electric, pneumatic

**CONNECTION**

Wafer: ANSI150 GB PN10

**PRESSURE RANGE**

PN0~PN10

**TEMPERATURE RANGE**

NBR: -20°C - +85°C  
 EPDM: -20°C - +120°C  
 VITON: -20°C - +150°C  
 Metal seal: MAX. 500°C

**MATERIALS**

Body: GGG40  
 CF8  
 CF8M  
 Disc: 304  
 316  
 Seal: NBR/EPDM/VITON/Metal

**EXTERNAL TEMPERATURE RANGE**

-10°C - +80°C

**PILOT MEDIA**

3~8bar

**OPTIONS**

3/2 or 5/2-way valve, Others on request

The above information is for reference only and Eicmation reserves the right to alter without prior notice



Type:  
 DBL/DAL-NB/DAL-LR  
 Hand operated knife gate valve/  
 Pneumatic knife gate valve/  
 Electric knife gate valve  
 PN10  
 150LB  
 GGG40  
 CF8  
 CF8M

**Parts list**

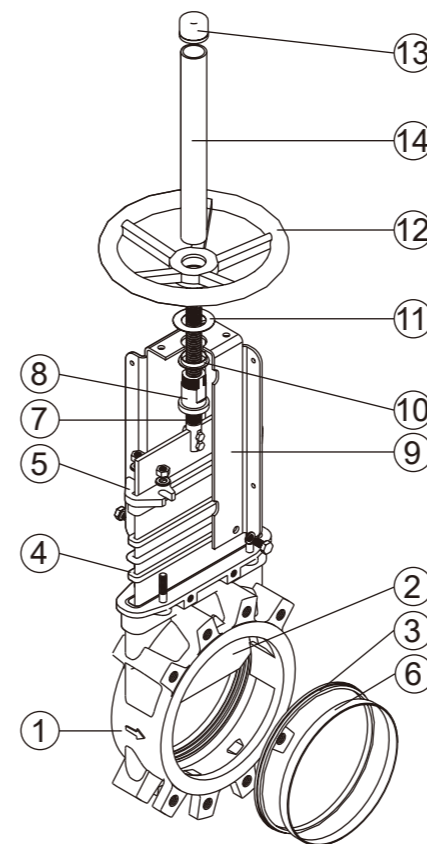

**TIGHTNESS**

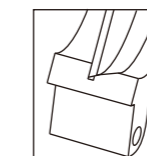

Metal/metal tightness

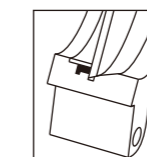

Rubber gasket tightness

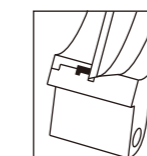

Reinforced seat support ring

**Ordering example:** e.g. DBL3342518

= Hand operated knife gate valve, CF8/304, NBR, PN10, Wafer, DN50 Knife gate valve

A. Type	B+C. Body/Internal	D. Sealing	E. Pressure criteria	F. Connection	G+H. Size		
DBL=Hand operated knife gate valve	03=GGG40/304	4=NBR	2=PN10	5=Wafer	18=2"	25=10"	32=28"
DAL-NB=Pneumatic knife gate valve	04=GGG40/316	6=VITON	3=150LB	A=ASME Wafer	19=2-1/2"	26=12"	33=30"
	33=CF8/304	7=EPDM			20=3"	27=14"	34=32"
	44=CF8M/316	D=Metal			21=4"	28=16"	35=34"
DAL-LR=Electric knife gate valve	34=CF8/316				22=5"	29=18"	36=36"
					23=6"	30=20"	37=38"
					24=8"	31=24"	38=40"

No.	Description	Material
1	Body	GGG40
		CF8
		CF8M
2	Gate	304 316
3	Seat	NBR/EPDM/VITON/Metal
4	Packing	PTFE
5	Gland	Aluminium(DN50 to DN300)
		Ductile iron(DN350 to DN1000)
		Stainless steel
6	"A"Ring	304
		316
7	Stem	Stainless steel
8	Stem nut	Brass
9	Yoke	Epoxy-coated Carbon steel
10	Collar	Nylon
11	Friction washer	Brass
12	Handwheel	Ductile iron
13	Cap	Plastic
14	Stem Protector	Epoxy-coated Carbon steel

**Dimension**

DBL-PN10

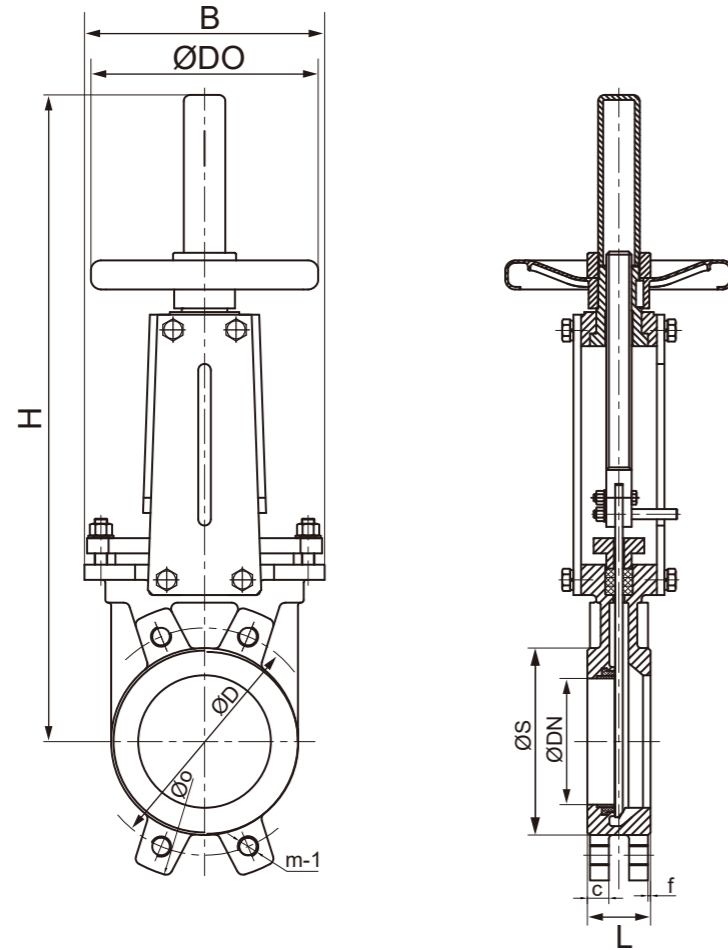

SIZE	DN	L	O	S	C	f	B	D	H	DO	M-1
2"	50	40	165	95	16	2	136	125	375	180	4-M16
2-1/2"	65	40	185	110	16	2	151	145	420	180	4-M16
3"	80	50	200	127	17	2	170	160	450	200	8-M16
4"	100	50	220	148	17	2	190	180	512	200	8-M16
5"	125	50	250	174	17	2	212	210	570	220	8-M16
6"	150	60	285	199	21	2	230	240	665	250	8-M20
8"	200	60	340	250	21	2	286	295	825	300	8-M20
10"	250	70	395	308	24	2	338	350	1000	350	12-M20
12"	300	70	445	360	24	2	388	400	1155	350	12-M20
14"	350	96	505	416	33	2	460	460	1310	400	16-M20
16"	400	100	565	466	35	2	520	515	1475	500	16-M24

**Dimension**

PN10

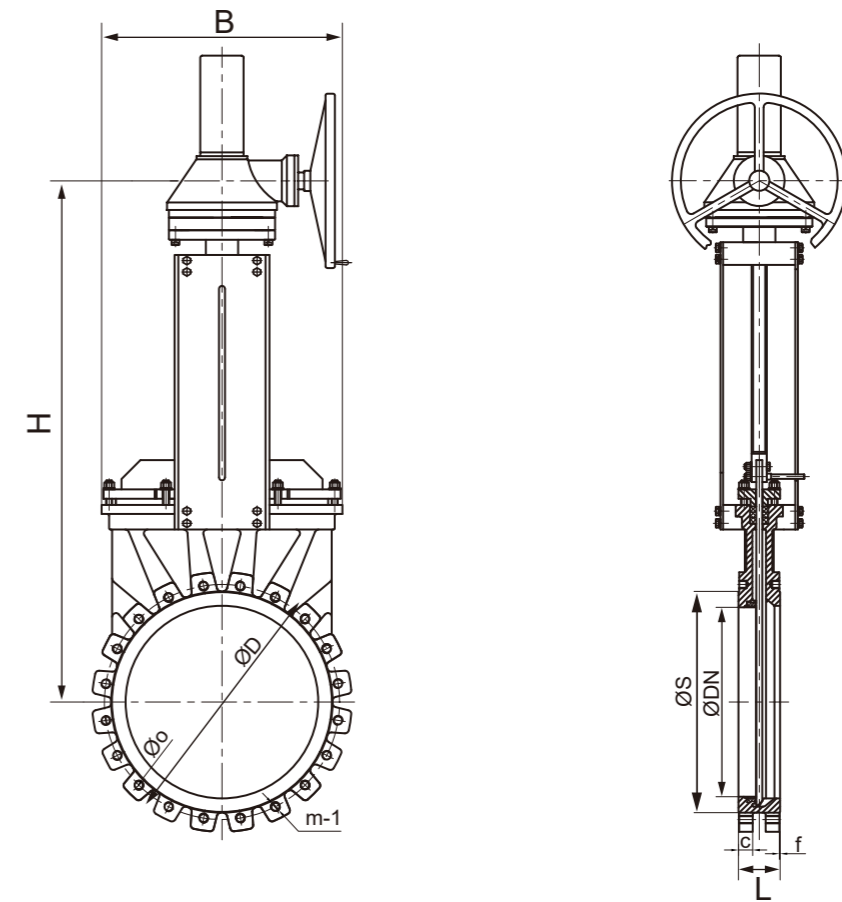

SIZE	DN	L	O	S	C	f	B	D	H	M-1
18"	450	106	615	525	36	2	585	565	1170	20-M24
20"	500	110	670	574	37	2	635	620	1280	20-M24
24"	600	110	780	664	37	2	720	725	1485	20-M27
28"	700	110	895	1070	38	2	807	840	1670	20-M27
32"	800	110	1015	955	38	2	922	950	1880	24-M30
36"	900	110	1115	955	38	2	1030	1050	2120	28-M30
40"	1000	110	1230	1080	38	2	1140	1160	2270	28-M33

**Dimension**

DBL-150LB

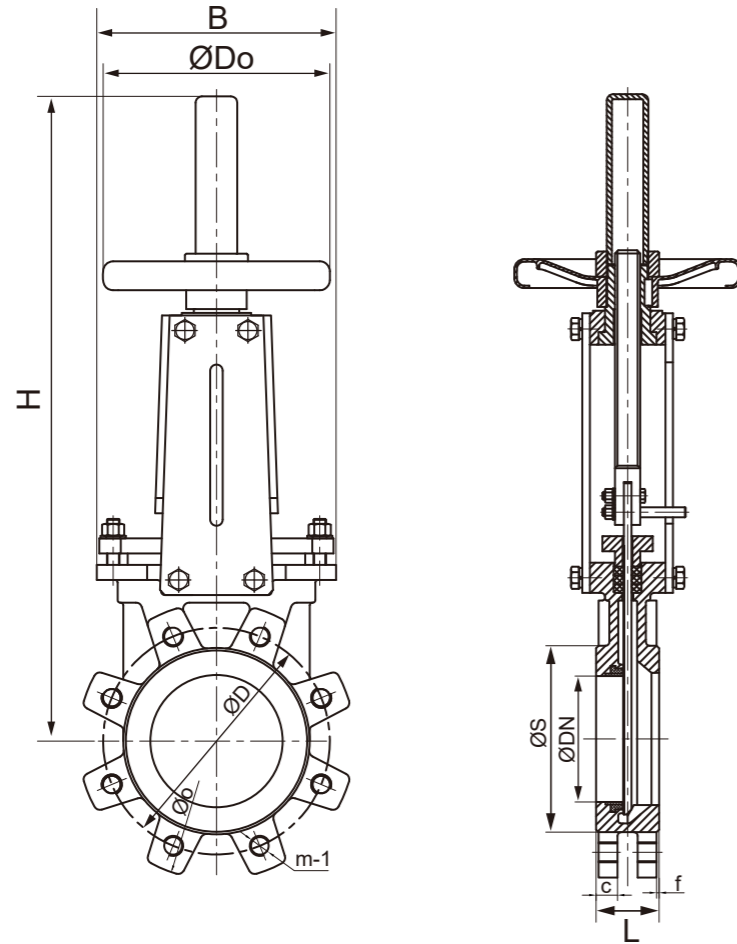

DN		L	O	DO	S	C	f	B	D	H	M-(UNC)
in	mm										
2"	50	48	152	120.5	95	16	1.6	136	120.5	375	4-M5/8"-11
2-1/2"	65	48	178	139.5	110	16	1.6	151	139.5	420	4-M5/8"-11
3"	80	51	190	152.5	127	17	1.6	170	152.5	450	4-M5/8"-11
4"	100	51	229	190.5	148	17	1.6	190	190.5	512	8-M5/8"-11
5"	125	57	254	216	174	17	1.6	212	216	570	8-M3/4"-10
6"	150	57	280	241.5	199	21	1.6	230	241.5	665	8-M3/4"-10
8"	200	70	343	298.5	250	21	1.6	286	298.5	825	8-M3/4"-10
10"	250	70	406	362	308	24	1.6	338	362	1000	12-M7/8"-9
12"	300	76	483	432	360	24	1.6	388	432	1155	12-M7/8"-9
14"	350	76	533	476	416	33	1.6	460	476	1310	12-M1"-8
16"	400	89	597	540	466	35	1.6	520	540	1475	16-M1"-8

**Dimension**

DAL-NB

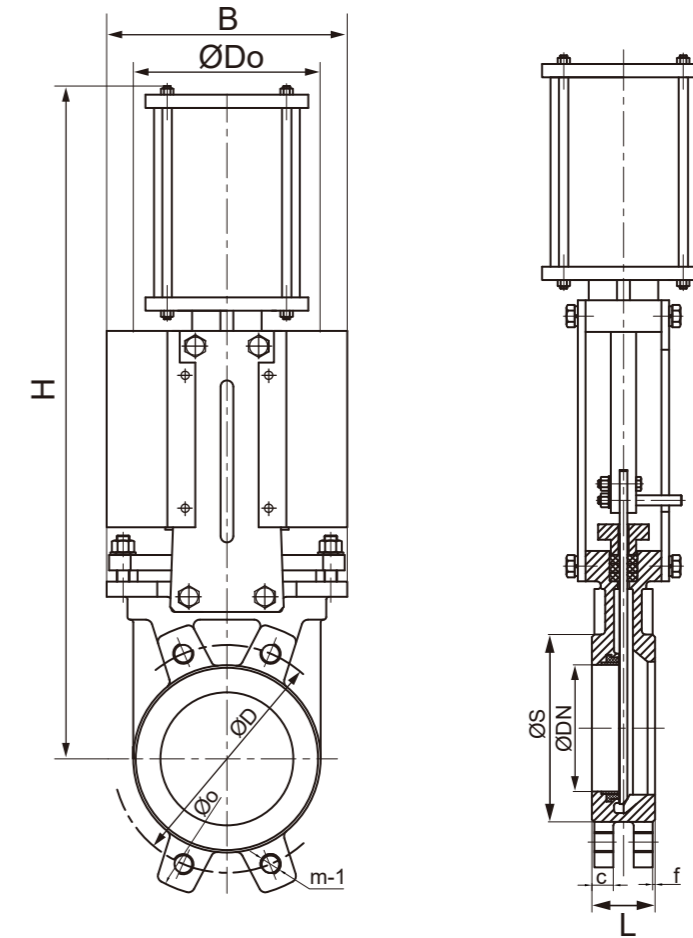

SIZE	DN	L	O	S	C	f	B	D	H	M-1
2"	50	40	165	95	16	2	136	125	430	4-M16
2-1/2"	65	40	185	110	16	2	151	145	460	4-M16
3"	80	50	200	127	17	2	170	160	510	8-M16
4"	100	50	220	148	17	2	190	180	570	8-M16
5"	125	50	250	174	17	2	212	210	660	8-M16
6"	150	60	285	199	21	2	230	240	720	8-M20
8"	200	60	340	250	21	2	286	295	890	8-M20
10"	250	70	395	308	24	2	338	350	1120	12-M20
12"	300	70	445	360	24	2	388	400	1230	12-M20
14"	350	96	505	416	33	2	460	460	1370	16-M20
16"	400	100	565	466	35	2	520	515	1570	16-M24
18"	450	106	615	525	36	2	585	565	1720	20-M24
20"	500	110	670	584	37	2	635	620	1850	20-M24
24"	600	110	780	664	37	2	720	725	2150	20-M27

## Dimension

### DAL-LR

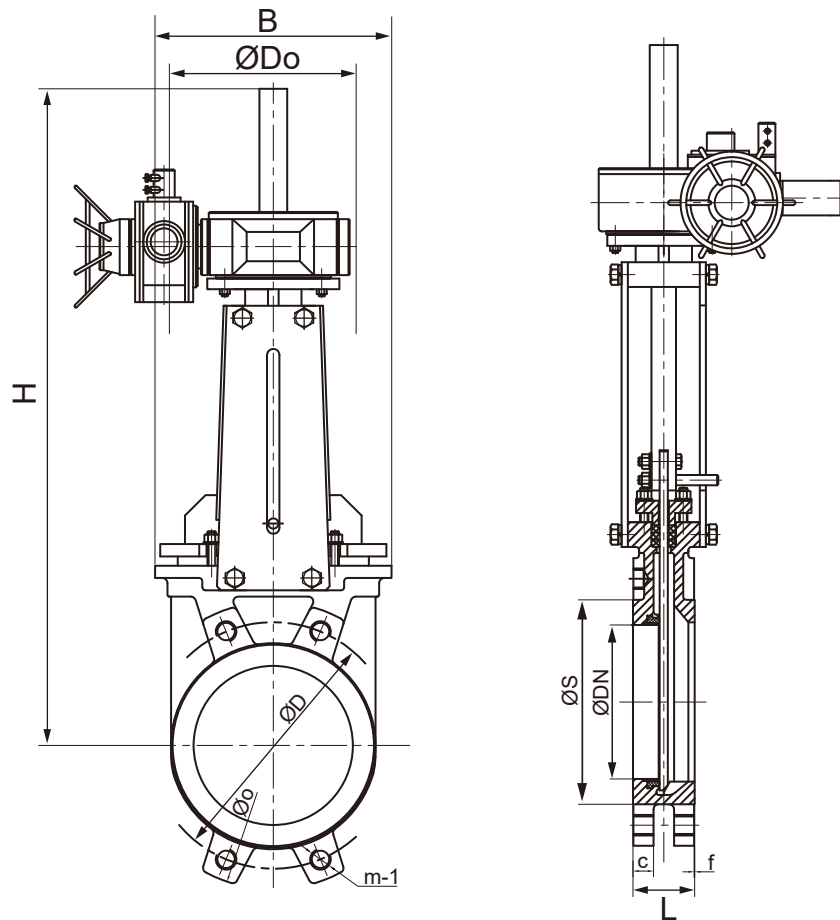

SIZE	DN	L	O	S	C	f	B	D	H	M-1
2"	50	40	165	95	16	2	136	125	640	4-M16
2-1/2"	65	40	185	110	16	2	151	145	670	4-M16
3"	80	50	200	127	17	2	170	160	695	8-M16
4"	100	50	220	148	17	2	190	180	755	8-M16
5"	125	50	250	174	17	2	212	210	810	8-M16
6"	150	60	285	199	21	2	230	240	875	8-M20
8"	200	60	340	250	21	2	286	295	1010	8-M20
10"	250	70	395	308	24	2	338	350	1125	12-M20
12"	300	70	445	360	24	2	388	400	1280	12-M20
14"	350	96	505	416	33	2	460	460	1410	16-M20
16"	400	100	565	466	35	2	520	515	1560	16-M24
18"	450	106	615	525	36	2	585	565	1730	20-M24
20"	500	110	670	584	37	2	635	620	1850	20-M24
24"	600	110	780	664	37	2	720	725	2125	20-M27
28"	700	110	895	1070	38	2	807	840	2480	24-M27
32"	800	110	1015	955	38	2	922	950	2860	24-M30
36"	900	110	1115	870	38	2	1030	1050	3090	24-M30
40"	1000	110	1230	760	38	2	1140	1160	3315	24-M27