



Specification

DESIGN

Body consists of 1 part, two flanges wafer connection. EN
DIN 2501, PN10, PN16,
ASME B16.5 ANSI 150HG/T20592
HG/T 20615

OPERATION

90 ° rotation of the handle, Each 10° lockable,
physical Indicator

CONNECTION

flange DN 50 - DN 600
Bigger sizes on request

FACE TO FACE LENGTH

DIN 3203/K1. (ISO 5752)

PRESSURE RANGE

DN 50 - DN 250: max. 16 bar
DN 300 - DN 600: max. 10 bar

TEMPERATURE RANGE

NBR: -20°C - +85°C
EPDM: -29°C - +120°C
VITON: -20°C - +150°C
PTFE: -30°C - +120°C
Silicone: -20°C - +180°C

MATERIALS

Body: Aluminum alloy (1 1/4")
GGG40
WCB
CF8
CF8M

Disc: GGG40+nickel
GGG40+nylon
CF8
CF8M

Stem seal: NBR / delrin

Shaft: Carbon steel

Seal: NBR/EPDM/VITON/PTFE/Silicone

Handle: Ductile iron

OPTIONS

Electrical position indicator
Lengthened handle
Handwheel device

The above information is for reference only and
Eicmation reserves the right to alter without prior
notice



Type:
FAA/FBA
Manual concentric butterfly valve
ISO5211 concentric butterfly valve

PN10-16
Alloy (1 1/4")
GGG40
WCB
CF8
CF8M

Pressure - Temperature-Diagram

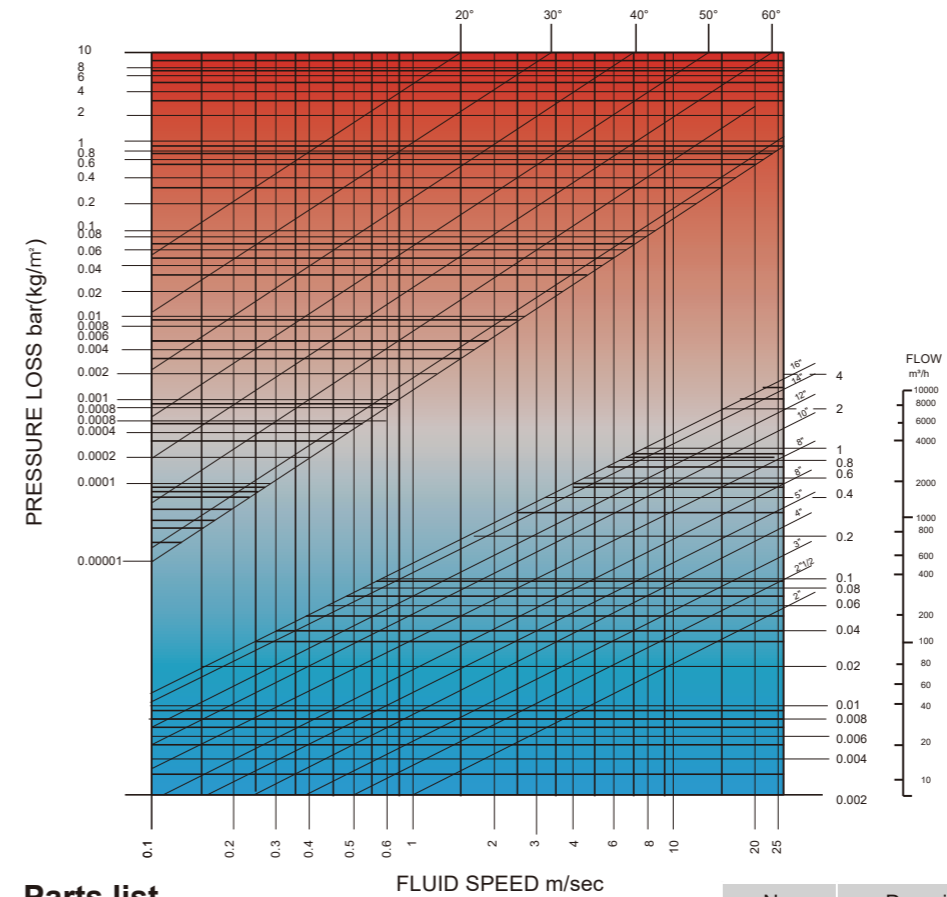

Parts list

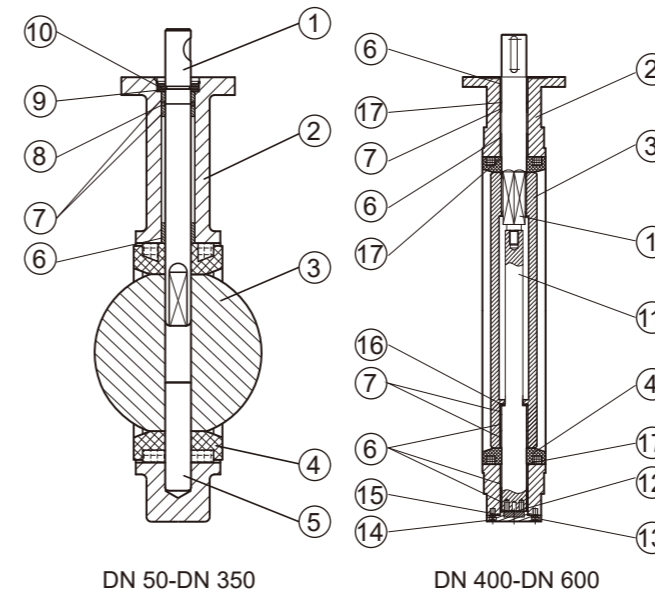

No.	Description	Material
1	Above stem	Stainless steel
2	Body	Alloy
		GGG40
		WCB
		CF8 CF8M
3	Disc	GGG40+Nickel
		GGG40+Nylon
		CF8
		CF8M
4	Seat	NBR/EPDM/FPM/PTFE
5	Lower stem	Stainless steel
6	Long lined shaft	bronze
7	Short lined shaft	bronze
8	Stem seal	NBR/EPDM/FPM
9	Non-return washer	PTFE
10	Split Loop	Metal
11	Lower valve shaft	Stainless steel
12	Bronze Pad	Bronze
13	Cap	Cast iron : DN50-DN300 Gray iron DN350-DN600 Ductile Iron
		WCB
		CF8 CF8M
14	Hexagon screw	Stainless steel
15	Body bottom O-ring	NBR/EPDM/FPM
16	Support pad	PTFE
17	O-ring	NBR/EPDM/FPM

Ordering example: e.g. FAA/FBA0N72526

= Manual concentric butterfly valve/High platform concentric butterfly valve, Cast iron/nylon, EPDM, PN10, DIN Wafer, DN300

Butterfly valve

A. Type	B+C. Body/Internal	D. Sealing	E. Pressure	F. Connection	G + H. Size	
FAA=Manual concentric butterfly valve	13=Alloy/CF8 (1 1/4") 14=Alloy/CF8M(1 1/4") 03=GGG40/CF8	2=PTFE 4=NBR 6=FPM	2=PN10(12"-24") 3=PN16(1 1/4"-10") /150LB	5=Wafer A=ASME Wafer 6=GB Flange L=LUG M=ASME Flange	16=1 1/4" 17=1 1/2" 18=2" 19=2 1/2" 20=3" 21=4" 22=5" 23=6"	24=8" 25=10" 26=12" 27=14" 28=16" 29=18" 30=20" 31=24"
FBA=ISO5211 concentric butterfly valve	04=GGG40/CF8M 0N=GGG40/Nylon 07=GGG40/Nickel 23=WCB/CF8 24=WCB/CF8M 33=CF8/CF8 44=CF8M/CF8M	7=EPDM E=Silicone				

Dimension

WAFER

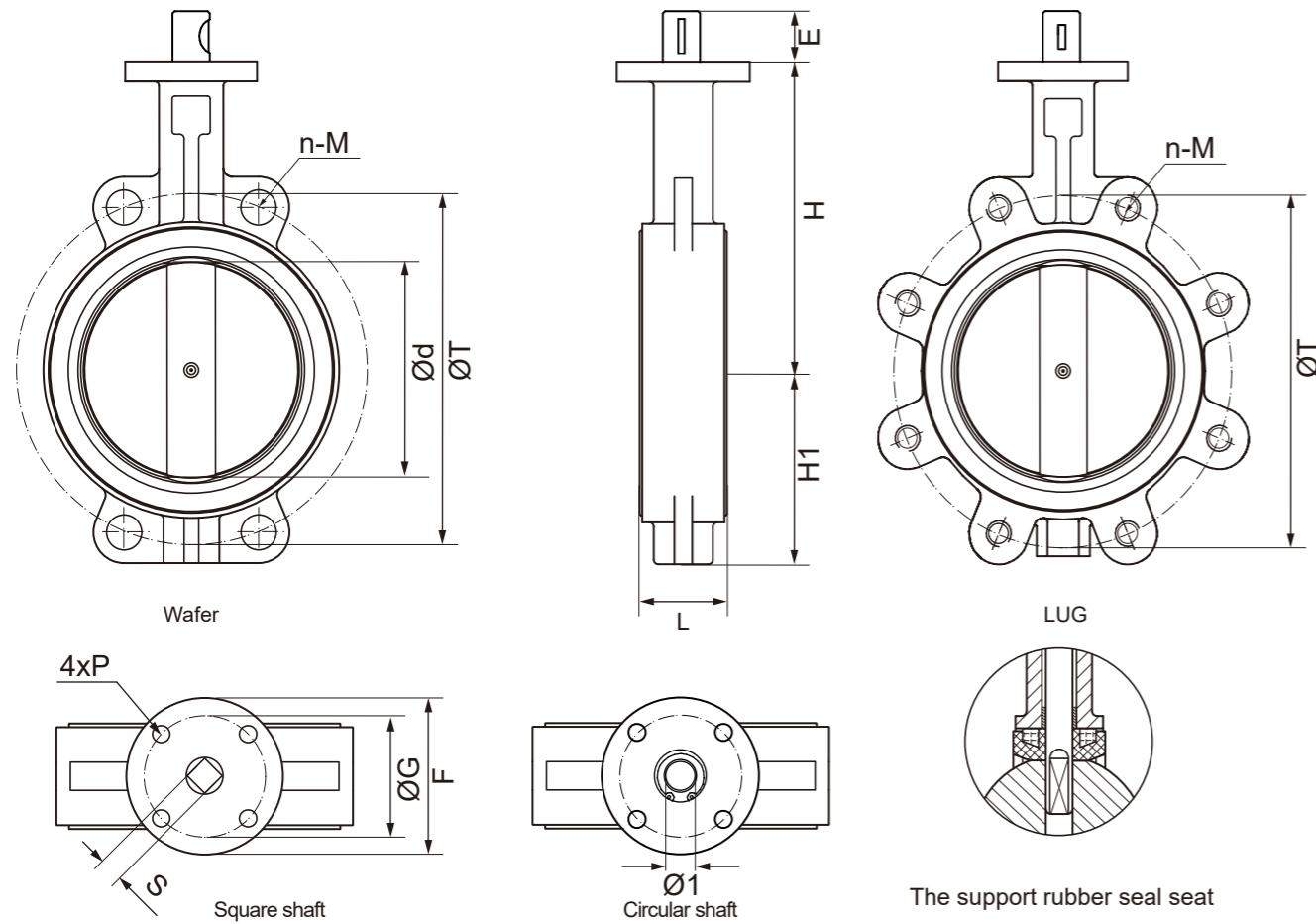

DN	Ød	L	H	H1	E	F	ØG	P	S	Ø1	ØT	n-M	Kg	
													Wafer	LUG
25	-	33	94	46	27	65	45/50	5.2/7.5	11	9.5	85	4-M12	1.1	-
32	-	33	94	46	27	65	45/50	5.2/7.5	11	9.5	100	4-M16	1.1	-
40	41	33	94	53	27	65	45/50	5.2/7.5	11	9.5	110	4-M16	1.2	-
50	51	42	140	55	27	90	50/70	7.5/10	11	14	125	4-M16	2.6	2.1
65	62.5	44	153	64	27	90	50/70	7.5/10	11	14	145	4-M16	3.4	2.4
80	77	44	159	73	27	90	50/70	7.5/10	11	14	160	8-M16	4	2.6
100	102.5	50	182	88	27	90	70	10	11	16	180	8-M16	4.6	4.5
125	121.5	56	190	102	27	90	70	10	14	19	210	8-M16	7	6.8
150	154.2	56	203	115	27	90	70	10	14	19	240	8-M20	8	8.3
200	200.5	60	241	149	40	120	102/125	12/14	17	22	295	12-M20	14	13
250	248.5	68	273	184	45	120	102/125	12/14	22	30	350	12-M20	21.5	18.8
300	299	78	311	207	50	150	102/125	14	22	30	400	12-M20	30.7	29
350	332	78	363	247	55	150	102/125	14	27	35	460	16-M20	44.5	39
400	377.5	102	375	275	64	200	125/140	18/22	27	40	515	16-M24	65	58
450	430	114	406	307	80	210	165	22	36	50	565	20-M24	95	72
500	488	127	438	330	80	210	165	22	36	50	620	20-M24	120	128
600	568	151	519	400	80	210	165	22	46	60	725	20-M27	170	178

⚠ DN25-DN200 flange holes connected with DIN 2501 PN16, DN250-DN600 flange holes connected with DIN 2501 PN10

Dimension

FLANGE

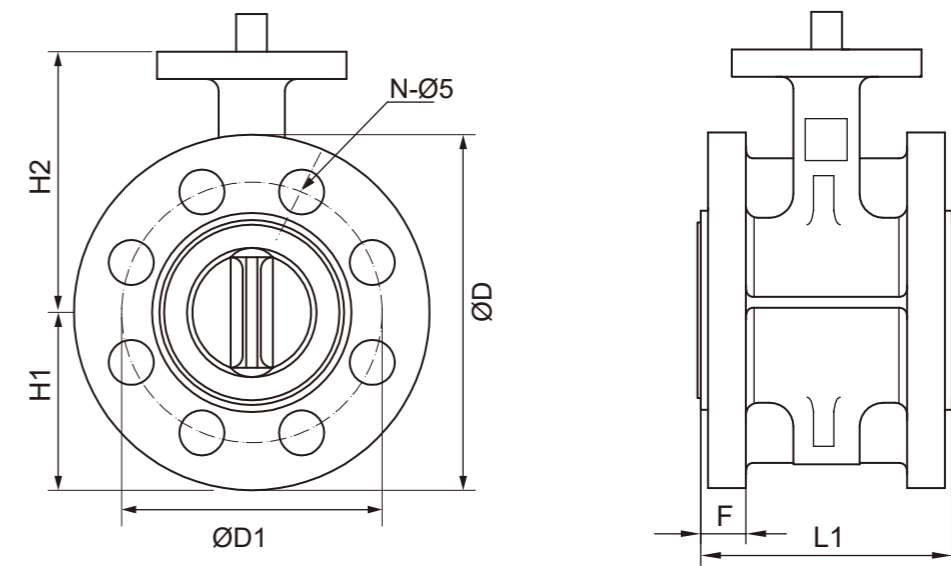

DN	H2	H1	L1	F	PN10			PN16		
					ØD	ØD1	N-Ø5	ØD	ØD1	N-Ø5
50	120	80	108	19	165	125	4-18	165	125	4-18
65	130	89	112	19	185	145	4-18	185	145	4-18
80	145	95	114	19	200	160	8-18	200	160	8-18
100	156	114	127	19	220	180	8-18	220	180	8-18
125	170	125	140	19	250	210	8-18	250	210	8-18
150	188	142	140	19	285	240	8-22	285	240	8-22
200	205	170	152	21	340	295	8-22	340	295	12-22
250	235	198	165	22	395	350	12-22	405	355	12-26
300	280	223	178	24.5	445	400	12-22	460	410	12-26
350	330	260	190	26.5	505	460	16-22	520	470	16-26
400	370	290	216	28	565	515	16-26	580	525	16-30
450	400	320	222	30	615	565	20-26	640	585	20-30
500	500	400	229	31.5	670	620	20-26	715	650	20-33
600	570	457	267	36	780	725	20-30	840	770	20-36

Dimension

Handle

DN50-DN200 valve

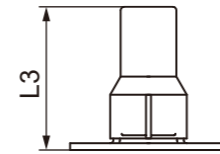
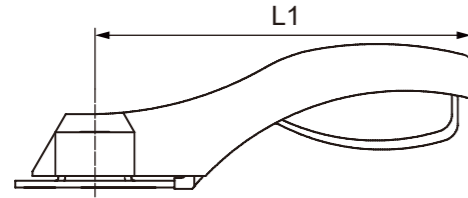

HandWheel

DN250-600 valve

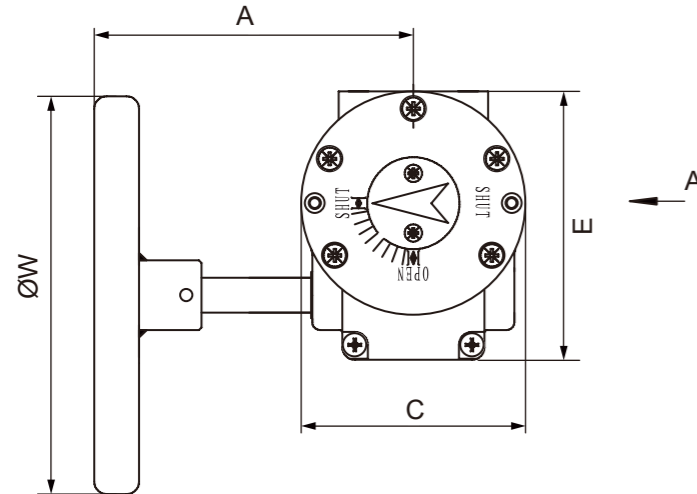

A向

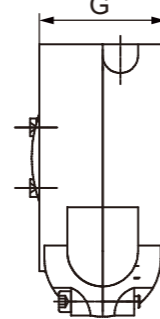

DN	L1	L3	A	C	E	G	ØW
25	115	30	120	80	110	50	140
32	115	30	120	80	110	50	140
40	115	30	120	80	110	50	140
50	170	70	120	80	110	50	140
65	170	70	120	80	110	50	140
80	170	70	120	80	110	50	140
100	215	80	110	100	130	55	140
125	215	80	110	100	130	55	140
150	215	80	110	100	130	55	140
200	355	80	175	140	187	68	250
250	-	-	175	140	187	68	250
300	-	-	185	154	210	78	290
350	-	-	185	154	210	78	290
400	-	-	301	257	252	94	350
450	-	-	301	257	252	94	350
500	-	-	254	199	199	155	300
600	-	-	301	256	256	174	400



Specification

DESIGN

Body consists of 1 part, two flanges wafer connection to DIN 2501, PN10, PN16, ASME B16.5 ANSI 150 HG/T20592 HG/T 20615

OPERATION

Pneumatic double-acting or single-acting

CONNECTION

Wafer flange DN 50 - DN 600, Bigger sizes on request.

FACE TO FACE LENGTH

DIN 3202/K1.(ISO 5752)

PRESSURE RANGE

DN50 - DN 300: max. 16 bar
DN 350 - DN 600: max. 10 bar

PILOT PRESSURE

2 - 8 bar
(Lower pilot pressure on request)

TEMPERATURE RANGE

NBR: -23°C - +85°C
EPDM: -29°C - +120°C
VITON: -20°C - +150°C
PTFE: -30°C - +120°C
Silicone: -20°C - +180°C

The above information is for reference only and Eicmation reserves the right to alter without prior notice

MATERIALS

Body: GGG40
Aluminum alloy
WCB
CF8
CF8M

Disc: GGG40+Nickel
GGG40+Nylon
CF8
CF8M

Stem seal: NBR
Shaft: Stainless Steel
Seal: NBR/EPDM/PTFE/Silicone

EXTERNAL TEMPERATURE RANGE

-20°C - +70°C

PILOT MEDIA

Filtered gases (oil, ash and water removal)

OPTIONS

3/2-ways or 5/2-ways valve, limit switch, positioner, filter reducer, manual clutch

For further specifications please refer to the butterfly valve (FBA) and actuator (PA) data sheet



Type:
FBA-PA

pneumatic concentric
butterfly valve
PN 10 -16
GGG40
Aluminum alloy
WCB
CF8
CF8M

Ordering example:

e.g. FBA0372718-PA1114110
= Concentric Butterfly Valve, GGG40/CF8, EPDM, PN10, DIN Flange, DN50, Pneumatic actuator, Double action, Anodising aluminium, Ø63mm, NBR, Gear, 0°-90°
Butterfly valve

A. Type	B+C. Body/Internal	D. Sealing	E. Pressure	F. Connection	G + H. Size
FBA=High platform center line butterfly valve	13=Aluminum alloy/CF8 (11/4") 14=Aluminum alloy/CF8M(11/4") 03=GGG40/CF8 04=GGG40/CF8M 0N=GGG40/Nylon 07=GGG40/Nickel 23=WCB/CF8 24=WCB/CF8M 33=CF8/CF8 44=CF8M/CF8M	2=PTFE 4=NBR 6=FPM 7=EPDM E=Silicone	2=PN10(12"-24") 3=PN16(11/4"-10") /150LB	5=Wafer A=ASME Wafer 6=GB Flange L=LUG M=ASME Flange	18=2" 26=12" 19=2 1/2" 27=14" 20=3" 28=16" 21=4" 29=18" 22=5" 30=20" 23=6" 31=24" 24=8" 25=10"

Actuator

I. Type	J. Function	K. Material	L + M. Size	N. Seal	O. Structure	P. Trip
PA=Pneumatic actuator	1=Double action 2=Single action-close 3=Single action-open	1=Aluminium alloy 2=Stainless steel	13=Ø52 22=Ø190 14=Ø63 23=Ø210 15=Ø75 24=Ø240 16=Ø83 25=Ø270 17=Ø92 26=Ø300 18=Ø105 27=Ø350 19=Ø125 28=Ø400 20=Ø140 21=Ø160	1=NBR 2=HNBR 3=FKM	1=Gear	0=0-90° 1=0-120° 2=0-135° 3=0-150° 4=0-180° 5=0-270°

Dimension

WAFER

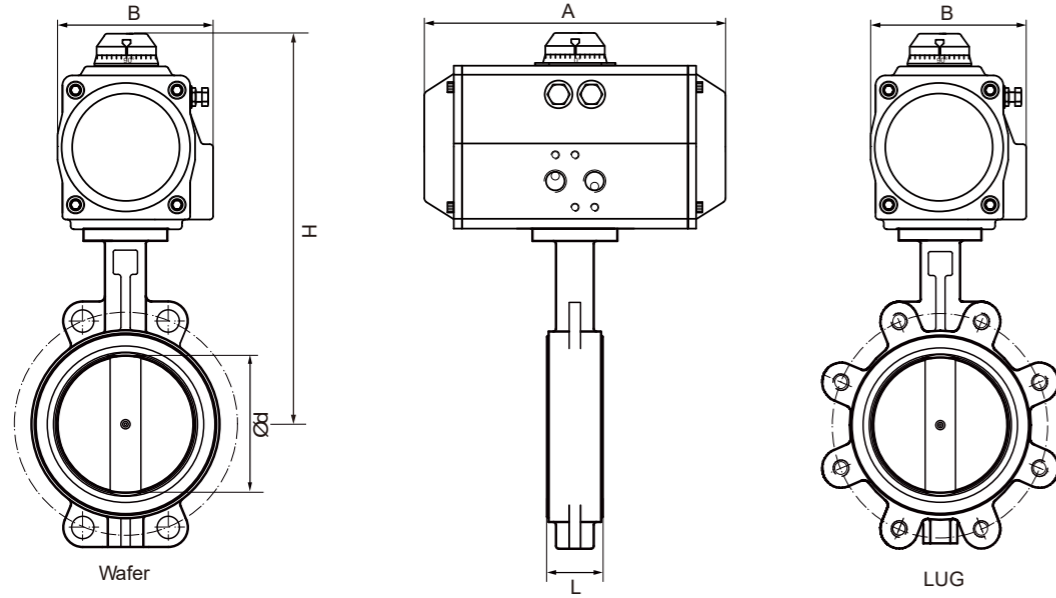

SIZE	DN	L	Ød	Actuator		A	B	H
				Model	Size			
1"	25	33	-	PA1113110	Ø52	147	72	196
				PA2114110	Ø63	172	83	212
1 1/4"	32	33	-	PA1113110	Ø52	147	72	196
				PA2114110	Ø63	172	83	212
1 1/2"	40	33	41	PA1113110	Ø52	147	72	196
				PA2115110	Ø75	184	95	224
2"	50	42	51	PA1113110	Ø52	147	72	242
				PA2115110	Ø75	184	95	270
2-1/2"	65	44	62.5	PA1114110	Ø63	172	83	271
				PA2116110	Ø83	204	103	292
3"	80	44	77	PA1115110	Ø75	184	95	289
				PA2117110	Ø92	262	109	306
4"	100	50	102.5	PA1116110	Ø83	204	103	321
				PA2118110	Ø105	268	122	345
5"	125	56	121.5	PA1117110	Ø92	262	109	337
				PA2118110	Ø105	268	122	353
6"	150	56	154.5	PA1118110	Ø105	268	122	366
				PA2119110	Ø125	301	142	388
8"	200	60	200.5	PA1119110	Ø125	301	142	426
				PA2120110	Ø140	390	152	444
10"	250	68	248.5	PA1120110	Ø140	390	152	476
				PA2121110	Ø160	458	174	545
12"	300	78	299	PA1121110	Ø160	458	174	539
				PA2122110	Ø190	525	206	573
14"	350	78	332	PA1122110	Ø190	525	206	625
				PA2123110	Ø210	532	226	650
16"	400	102	377.5	PA1123110	Ø210	532	226	662
				PA2124110	Ø240	660	260	696
18"	450	114	430	PA1124110	Ø240	660	260	727
				PA2125110	Ø270	740	294	766
20"	500	127	488	PA1125110	Ø270	740	294	798
				PA2126110	Ø300	798	324	822
24"	600	151	568	PA1125110	Ø270	740	294	889
				PA2127110	Ø350	880	380	957

Note:Details please refer to FAA/FBA Manual concentric butterfly valve;
The above are NBR/EPDM seats, Information is under normal working conditon,
Please consult the technical department in case of special working conditions

⚠ DN50-DN200 flange holes connected in line with DIN 2501 PN16,DN250-DN600 flange holes connected in line with DIN 2501 PN10

Dimension

FLANGE

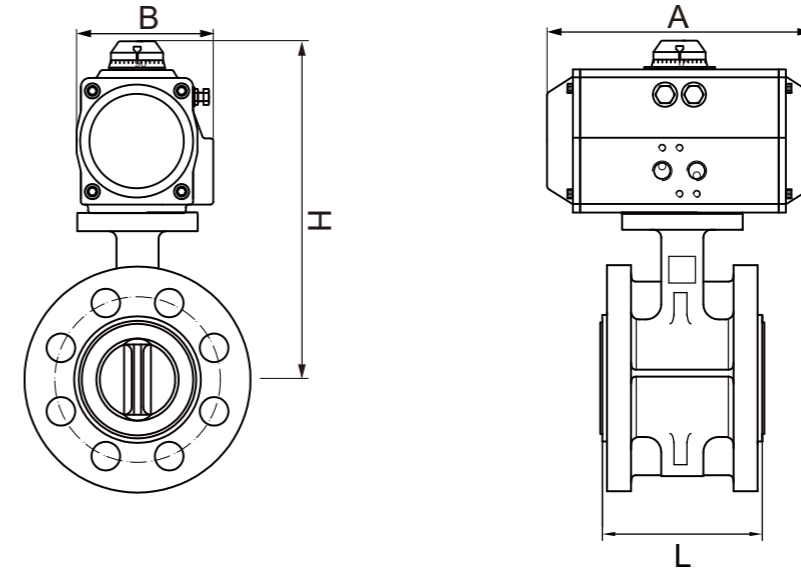

SIZE	DN	Actuator		A	B	H	L
		Model	Size				
2"	50	PA1113110	Ø52	147	72	222	108
		PA2115110	Ø75	184	95	250	
2-1/2"	65	PA1114110	Ø63	172	83	248	112
		PA2116110	Ø83	204	103	269	
3"	80	PA1115110	Ø75	184	95	275	114
		PA2117110	Ø92	262	109	292	
4"	100	PA1116110	Ø83	204	103	295	127
		PA2118110	Ø105	268	122	319	
5"	125	PA1117110	Ø92	262	109	317	140
		PA2118110	Ø105	268	122	333	
6"	150	PA1118110	Ø105	268	122	351	140
		PA2119110	Ø125	301	142	373	
8"	200	PA1119110	Ø125	301	142	390	152
		PA2120110	Ø140	390	152	408	
10"	250	PA1120110	Ø140	390	152	438	165
		PA2121110	Ø160	458	174	463	
12"	300	PA1121110	Ø160	458	174	508	178
		PA2122110	Ø190	525	206	542	
14"	350	PA1122110	Ø190	525	206	592	190
		PA2123110	Ø210	532	226	617	
16"	400	PA1123110	Ø210	532	226	657	216
		PA2124110	Ø240	660	260	661	
18"	450	PA1124110	Ø240	660	260	721	222
		PA2125110	Ø270	740	294	760	
20"	500	PA1125110	Ø270	740	294	860	229
		PA2126110	Ø300	798	324	884	
24"	600	PA1125110	Ø270	740	294	930	267
		PA2127110	Ø350	880	380	1008	

Note:Details please refer to FAA/FBA Manual concentric butterfly valve;
The above are NBR/EPDM seats, Information is under normal working conditon,
Please consult the technical department in case of special working conditions



Specification

DESIGN

Body consists of 1 part,two flanges wafer connection,DIN 2501,PN10,PN16,ASME B16.5 ANSI 150 HG/T20592 HG/T 20615

Stem seal: NBR
Shaft: Stainless Steel
Seal: NBR/EPDM/PTFE/Silicone

EXTERNAL TEMPERATURE RANGE
-20°C - +60°C

OPTIONAL VOLTAGE
24V DC,24V AC,110V AC,220V AC,380V AC

PROTECTION
IP 67

STANDARD EQUIPMENT
additional limit switches, optical position indicator, manual override

OPTIONS
Potentiometer modulate type 4-20mA
Exd IIB T4 For more requests please contact us

For further specifications please refer to the butterfly valve (FBA) and actuator (KL) data sheet

The above information is for reference only and Eicmation reserves the right to alter without prior notice

OPERATION

Electric with handle operation

CONNECTION

Wafer flange DN50 - DN600
Bigger sizes on request.

PRESSURE RANGE

DN 50 - DN 300: max. 16 bar
DN 350 - DN 600: max. 10 bar

TEMPERATURE RANGE

NBR: -23°C - +85°C
EPDM: -29°C - +120°C
VITON: -20°C - +150°C
PTFE: -30°C - +120°C
Silicone:-20°C - +180°C

MATERIALS

Body: GGG40
Aluminum alloy
WCB
CF8
CF8M

Disc: GGG40+Nickel/Nylon
CF8
CF8M



Type:
FBA
Electric concentric butterfly valve
PN10/16
Aluminum alloy
GGG40
WCB
CF8
CF8M

Dimension
WAFER

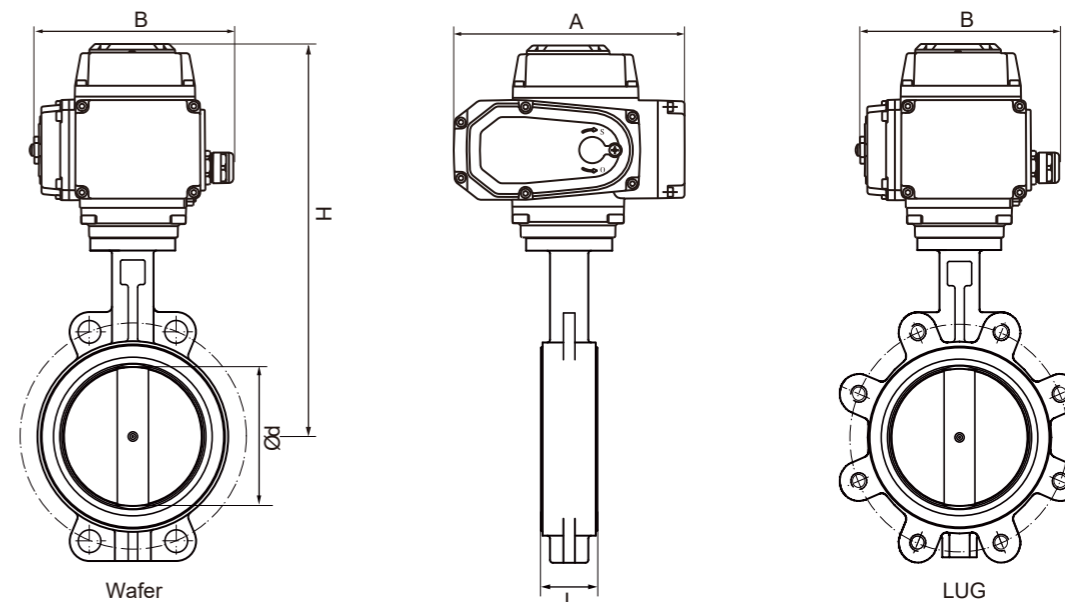

SIZE	DN	L	Ød	Actuator		A	B	H
				Model	Torque (NM)			
1"	25	33	-	KL111111	50	165	140.5	277.5
				KL121111	50	170.5	120.5	290
1 1/4"	32	33	-	KL111111	50	165	140.5	277.5
				KL121111	50	170.5	120.5	290
1 1/2"	40	33	41	KL111111	50	165	140.5	284.5
				KL121111	50	170.5	120.5	297
2"	50	42	51	KL111111	50	165	140.5	332.5
				KL121111	50	170.5	120.5	345
2-1/2"	65	44	62.5	KL111111	50	165	140.5	354.5
				KL121111	50	170.5	120.5	367
3"	80	44	77	KL111111	50	165	140.5	369.5
				KL121111	50	170.5	120.5	382
4"	100	50	102.5	KL111311	100	211.5	154	438.5
				KL121311	100	217.5	139	452
5"	125	56	121.5	KL111311	100	211.5	154	460.5
				KL121311	100	217.5	139	474
6"	150	56	154.5	KL111511	200	259	186	521
				KL121511	200	217.5	139	500
8"	200	60	200.5	KL111511	200	259	186	593
				KL121511	200	217.5	139	572
10"	250	68	248.5	KL111711	400	259	186	660
				KL121711	400	266.5	170	670
12"	300	78	299	KL111911	600	259	186	721
				KL121911	600	266.5	170	731
14"	350	78	332	KL112111	1000	283	193	839.5
				KL122111	1000	-	-	-
16"	400	102	377.5	KL112111	1000	283	193	879.5
				KL122111	1000	-	-	-
18"	450	114	430	KL112311	2000	283	193	942.5
				KL122311	2000	-	-	-
20"	500	127	488	KL112311	2000	283	193	997.5
				KL122311	2000	-	-	-
24"	600	151	568	-	-	-	-	-
				-	-	-	-	-

Ordering example: e.g. FBA0372618-KL411111
=ISO5211concentric butterfly valve, GGG40/CF8,EPDM,DN50,PN10, GB Flange , Electric actuator 50Nm,220V AC,Explosion proof grade IP67, On/Off+dry contract
Butterfly valve

A. Type	B+C. Body/Internal	D. Sealing	E. Pressure criteria	F. Connection	G + H. Size	
FBA=ISO5211 Center line butterfly valve	13=Alloy/CF8 (11/4") 14=Alloy/CF8M(11/4") 03=GGG40/CF8 04=GGG40/CF8M 0N=GGG40/Nylon 07=GGG40/Nickel 23=WCB/CF8 24=WCB/CF8M 33=CF8/CF8 44=CF8M/CF8M	2=PTFE 4=NBR 6=FPM 7=EPDM E=SILICONE	2=PN10(12"-24") 3=PN16(11/4"-10") /150LB	5=Wafer A=ASME Wafer 6=GB Flange L=LUG M=ASME Flange	18=2" 19=2 1/2" 20=3" 21=4" 22=5" 23=6" 24=8" 25=10"	26=12" 27=14" 28=16" 29=18" 30=20" 31=24"

I. Type	J. Voltage	K. Explosion proof grade	L+M. Torque(NM)	O. Extra	P. Spare
KL=Basic angle stroke Electric actuator	1=24V DC 2=24V AC 3=110V AC 4=220V AC 5=380V AC	1=IP67 2=IP68 3=Exd II BT4 (50-600NM)	11=50 13=100 15=200 17=400 19=600 21=1000 23=2000	1=On/Off type +dry contact 2=Modulate type 4~20mA	1=No 2=1K~10K potentiometer 3=Current position sensor 4~20mA 4=Overload protection (200-2000NM) 8=Arefaction protect

Note:Details please refer to FAA/FBA Manual concentric butterfly valve;
The above are NBR/EPDM seats, Information is under normal working condition,
Please consult the technical department in case of special working conditions

DN50-DN200 flange holes connected with DIN 2501 PN16,DN250-DN600 flange holes connected with DIN 2501 PN10

Dimension FLANGE

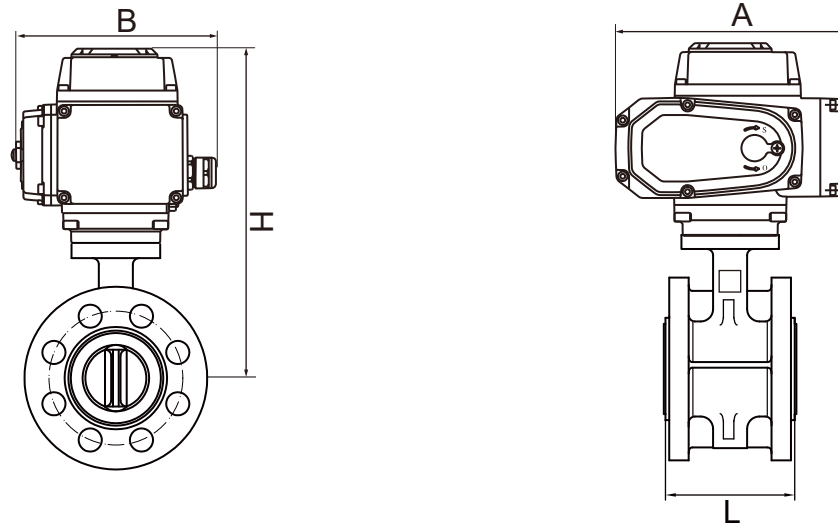

SIZE	DN	L	Actuator		A	B	H
			Model	Torque (NM)			
2"	50	108	KL111111	50	165	140.5	337.5
			KL121111	50	170.5	120.5	350
2-1/2"	65	112	KL111111	50	165	140.5	356.5
			KL121111	50	170.5	120.5	369
3"	80	114	KL111111	50	165	140.5	377.5
			KL121111	50	170.5	120.5	390
4"	100	127	KL111311	100	211.5	154	438.5
			KL121311	100	217.5	139	452
5"	125	140	KL111311	100	211.5	154	463.5
			KL121311	100	217.5	139	477
6"	150	140	KL111511	200	259	186	533
			KL121511	200	217.5	139	512
8"	200	152	KL111511	200	259	186	578
			KL121511	200	217.5	139	557
10"	250	165	KL111711	400	259	186	636
			KL121711	400	266.5	170	646
12"	300	178	KL111911	600	259	186	706
			KL121911	600	266.5	170	716
14"	350	190	KL112111	1000	283	193	819.5
			KL122111	1000	-	-	-
16"	400	216	KL112111	1000	283	193	889.5
			KL122111	1000	-	-	-
18"	450	222	KL112311	2000	283	193	949.5
			KL122311	2000	-	-	-
20"	500	229	KL112311	2000	283	193	1130
			KL122311	2000	-	-	-
24"	600	267	-	-	-	-	-
			-	-	-	-	-

Note: Details please refer to FAA/FBA Manual concentric butterfly valve;
The above are NBR/EPDM seats, Information is under normal working condition,
Please consult the technical department in case of special working conditions